

Kilsyth Anderson Parish Church



GLASGOW
PRESBYTERY of



Parish Profile - June 2021

Contents

Introduction	Page 2
History	Page 3
Our Vision	Page 4
Community	Page 5
Parish	Page 6 - 8
Our Situation	Page 9
Worship	Page 10 – 13
Pastoral Care	Page 14
Christian Education	Page 15
Ecumenical	Page 16
World Mission	Page 17
The Sanctuary	Page 18 – 19
Church Halls	Page 20
Manse	Page 21
Special Events	Page 22
Local Church Review	Page 23
Our Minister	Page 24
Statistics	Page 25
Web Links	Page 26
Application Details	Page 27

Introduction

For family reasons, our minister for the past 8 years, recently translated to a new charge. This has caused us to seek a new minister on unrestricted tenure.

We trust that God will bring us the person who has the strength and vision to direct us, to help us grow and build on foundations which have been laid over many years' past ministries.

The Kirk Session has decided not to depart from the tradition regarding same sex marriages and civil partnerships.

If you are still interested, please read on!

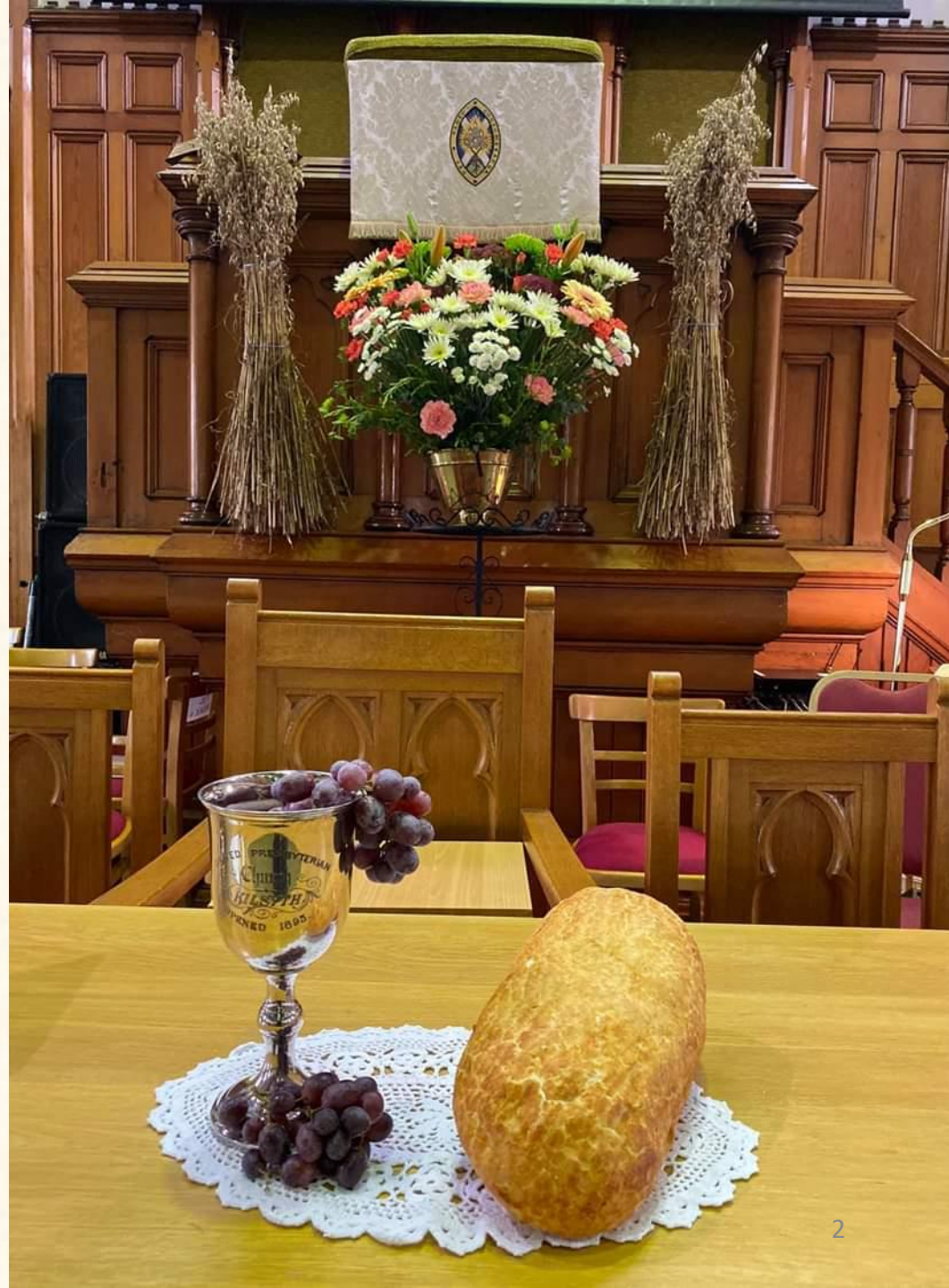



History

1768 saw the foundation of this Congregation.

It became known as Kilsyth Anderson Church because of the faithful service of Rev. John Anderson and his son Rev. Robert Anderson. Father and son occupied the same ministry for 114 years.

This Church congregation celebrated 250 years of preaching God's word in 2018.

During these 250 years there have been only 12 ministers.

Our Vision

To deepen and develop our worship

To see others coming to living faith and join us in worship and service

To encourage fellowship, Bible study and prayer

To be a witness to Jesus' love in our community



Community

Kilsyth Anderson is part of the parish grouping known locally as 'Kirks the Gither', (a group of Church of Scotland Churches) the other members being Kilsyth Burns and Old and Twechar Parish Churches. The town has a total of 7 places of worship and a wonderful history of revival.



A work Party from Anderson support the Fabric Fund via popular fayres in June and at Christmas. These events are enjoyed by the whole community.

We also have involvement with Kilsyth & District Churches Connecting Together (a group formed from all denominations). This group organises the joint Big Picnic event and the Good Friday Walk of Witness.

Members of our congregation are involved with religious services in the local Cottage Hospital and Craig-en-Goyne Nursing Home. These duties are shared with the other local churches.



Parish

Anderson Church serves the North side of Kilsyth, also the villages of Queenzieburn and Banton. Kilsyth is a small friendly town. There is a more rural population in the surrounding farms and villages. The populace is currently around nine thousand. There are two new housing estates comprising several hundred units. Population movement is minimal; hence there is a strong community spirit.

There are many lovely local areas for walking/cycling, including Colzium Estate, Dumbreck Marsh and the tow paths of the Forth and Clyde canal both east and west from Auchinstarry marina.



Parish

Kilsyth is very central and is within easy commuting distance to Glasgow (approx.30 mins), Edinburgh (50 mins) and Stirling (25 mins).



Croy station - with excellent services both East and West - is within a 10 minute drive and there is a regular bus service from Kilsyth to Buchanan Street, Glasgow.



Cumbernauld is less than a 15 minute drive away and hosts two modern sports centres, a shopping centre, various supermarkets and all the fast food outlets you could imagine!



Parish

There are four nurseries, four non-denominational primary schools, one Roman Catholic primary school and a non-denominational secondary school in the area.

Balmalloch Primary School, with approximately 350 pupils, has 3 services each year in Anderson Church and our minister attends monthly assemblies in the school. Another Primary school, in the village of Banton, is within our parish. Banton is a small school with around 45 children. Banton Primary is a partnership school with Chapelgreen Primary and Nursery Class in Queenzieburn.

Kilsyth Academy also falls within our parish. Around 500 pupils from Kilsyth and its neighbouring villages are educated in this non-denominational school.

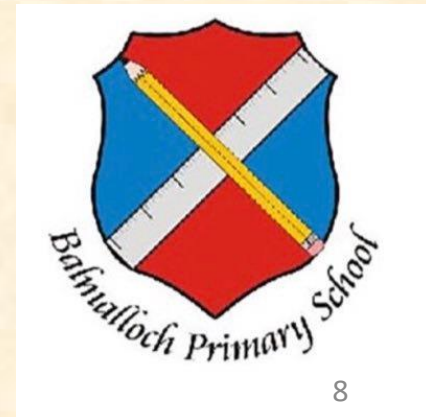



Our Situation

We are strong in faith but need stability and confidence

We are warm and welcoming but sometimes small in number

We are steeped in history but welcome change

We are varied in age but worship as a family

We are in a small town but need vision for wider ministry

We are rich in talent but require leadership

We are prayerfully waiting to embrace the future.

Worship

Sunday worship is held weekly at 11a.m.
Evening services begin at 6.30pm (held irregularly)
Tea, coffee and fellowship are enjoyed afterwards.



Our sanctuary is warm and welcoming. Our worship style is traditional, but not stuffy.
Teachings are always scripture based, but appropriate for the world today.
We enjoy hymns from MP and also use the screens for more upbeat & modern worship music. Songs, choruses and hymns can be “requested” at special services on the calendar e.g. during Advent.

Members of the congregation frequently participate in the Sunday services by leading prayers of intercession and sharing God’s word with a Bible reading.

Worship

The children enjoy participating in the Children's address prior to going into the hall for their own activities. During the year, guest speakers also attend and we have family services led by the BB, GB and JAM club.

Prior to lockdown, there were several mid-week Fellowship meetings. At present there is one meeting per week by ZOOM.

A Pause for Prayer time is held on Fridays during the Drop In Café.

Our worship pattern is fairly orthodox, but we are open to change.

Communion is celebrated 4 times per annum. Children don't participate, but do have their own celebration in JAM Club.



Remembrance



Christmas gift service



JAM club nativity

During the year, we have several special services....



Harvest Sunday



Day of prayer



Back to church Sunday



Back to school

... and support various charities.

Worship

Retiring Offerings are used as appropriate throughout the year to support some of the above charities and others.

Live Streaming equipment has been installed. It is used every Sunday and for special services such as Funerals and Weddings. A CD ministry is available for the housebound.

We have a regular organist playing hymns from Mission Praise.

As part of the Parish Grouping there is a pulpit exchange during January and joint services are held in various churches during Easter week.

A Walk of Witness, organised by Kilsyth and District Churches Connecting Together, is held annually on Good Friday. The walk ends at Anderson for tea and coffee with home baking.

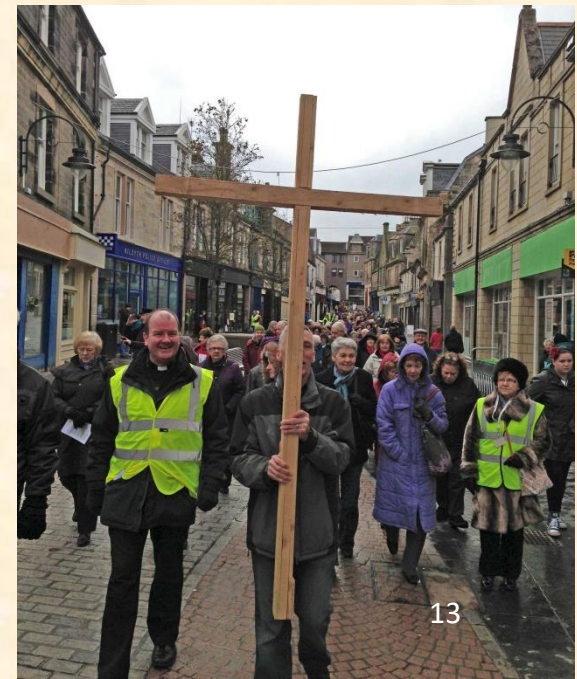



Pastoral Care

A designated group regularly call upon members and inform the minister of any pastoral needs. The group consists of elders and members of the congregation .

The Manse family has a designated pastoral visitor.

A newsletter is delivered to all members bi-monthly.



Christian Education

Children's Christian Education is delivered through the JAM Club (Jesus and Me) and through our uniformed organisations.

Our Jam Club has currently around 12 members and there are around 100 members of BB and GB.

Holiday Club – run by members of all the local churches reaches out to around 80 primary aged children each summer.

LMN - known as the last Monday night group (because they meet on the last Monday night of each month) is an all churches group, which is open to teenagers. Held in Kilsyth Community Church, it is attended by some of our teenagers.

Christianity Explored classes are held as required, both for adults and young people.

Ecumenical

There is a local clergy group which meets occasionally. All denominations are represented.

Stewardship

A copy of the financial accounts is available on request.

Staffing

Church officer duties are carried out by volunteers from the congregation.

Part – time office assistance is available if required.

World Mission

Christian Aid, National Bible Society and other charitable groups, working to relieve poverty and in disaster areas, are supported by our congregation.

The BB has a link with a school in Malawi which they visit and complete work in every couple of years. The congregation supports the BB in fundraising for this work.

Prayers of intercession for the world are a regular part of worship and the Mid-week Fellowship.





The Sanctuary

The Sanctuary dating from 1893 is reasonably well maintained, in good condition and is always warmly welcoming. There is a gallery and disabled access. Sanctuary development plans have been drawn up and some funding is available. However, plans have been delayed because of Covid.

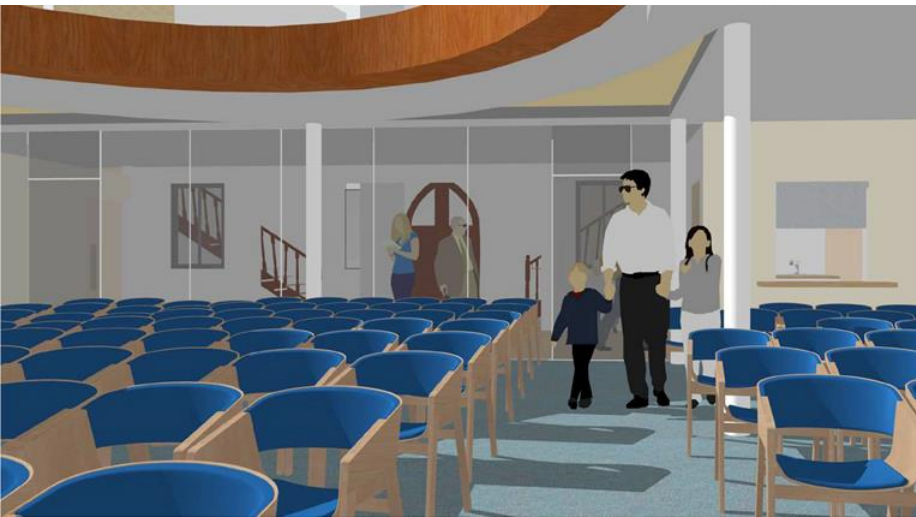
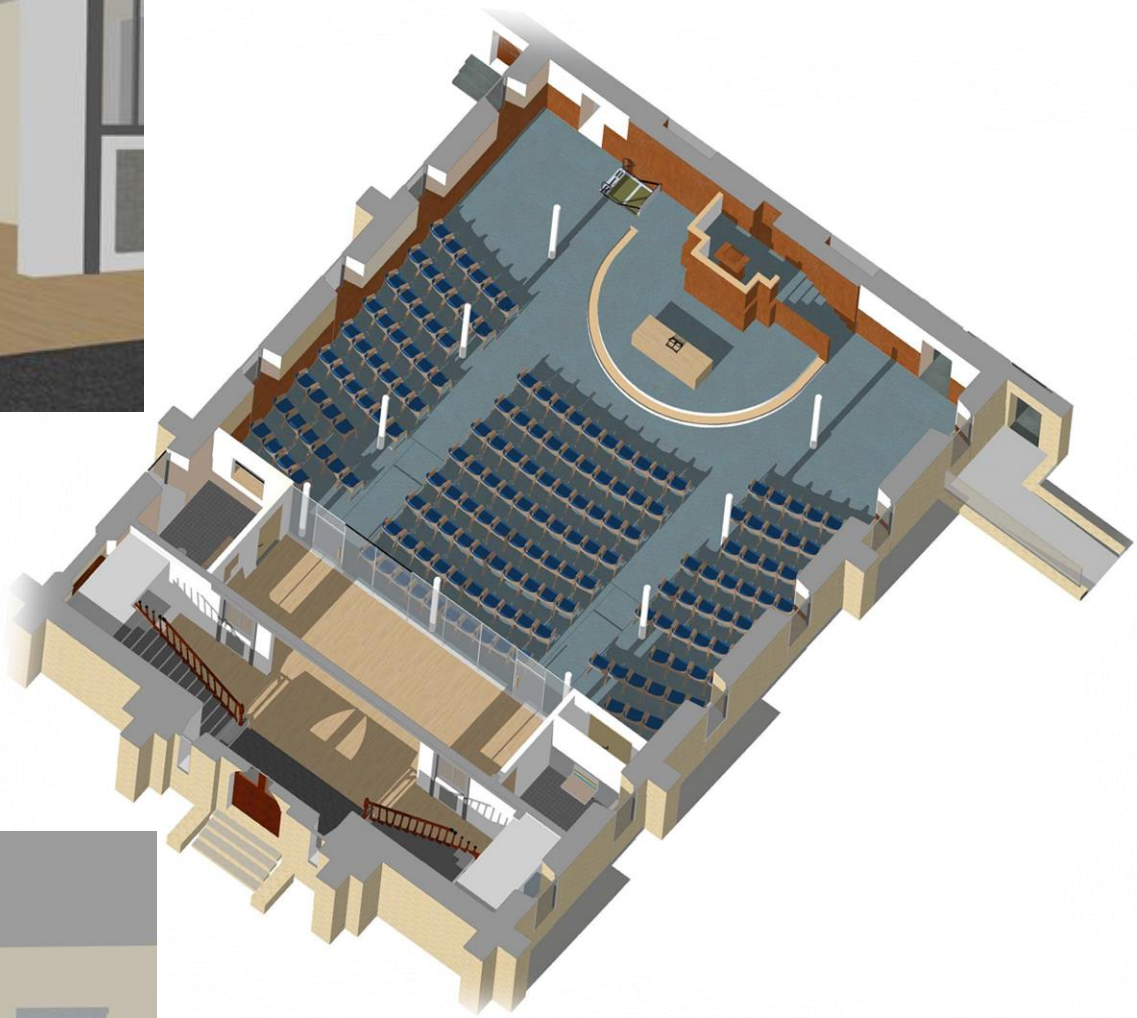

Sanctuary development plans

Halls

Adjoining the sanctuary there is one large hall with a platform / stage and three smaller halls. We have 2 adjoining kitchen areas. The Wyper Hall hosts the Drop In Café, the Bible study groups and other groups. There is a small, well equipped office. All are well cared for and cleaned weekly by a team of volunteers.

The halls are used by the following groups :

- Monday morning : Ladies bowling
- Monday evening : Guild meeting
- Tuesday evening : Girls' Brigade – Explorers, Juniors, Brigaders
- Tuesday evening : Work party (as required) to raise funds for fabric
- Wednesday afternoon : Bible & Blether group
- Wednesday evening : Boys' Brigade – Anchor boys, Juniors, Company, Seniors
- Thursday evening : Midweek fellowship
- Friday morning : Drop-In Café & Pause for Prayer



Manse



The Manse is a large house with 5 bedrooms, 3 public rooms, a study and 2 bathrooms/shower rooms. It is situated in the grounds behind the Church. The building is well maintained and the beautiful private gardens are looked after by an excellent team of volunteers. There is also a garage at the rear of the property.



Other Special Events

Visits from Claudius England

Over 70s' annual dinner

Office Bearers' Conference

Film evenings

The Gathering

Soup and Sandwich lunch

Afternoon of Prayer

Christmas Carol Concert

Messy Church





Local Church Review Plan

Renovation of sanctuary

Reform Mission Group and link with communication group, with other churches in our Parish Grouping

Create a new youth agenda – Holiday Club, LMN, Messy Church

Reform the spiritual development group.



Our Minister

Will follow a clear sense of God's call to this congregation

Will teach us faithfully & prayerfully from God's word

Will have a plan for outreach / evangelism

Will promote the work amongst young people

Will consolidate on-going pastoral care

Will be friendly, approachable and compassionate

Will be encouraged and supported to pursue personal and spiritual development

Kilsyth Anderson Parish Church of Scotland
Statistical Information for 2020

Members	218
Adherents	69
Deaths	11
Blessings	1
Baptisms	1
Weddings	1
Funerals	23





Useful links

Livestream services

<https://www.youtube.com/channel/UCebfKn7pylH3aArgVtKvudg/videos?view=57>

Church Facebook <https://www.facebook.com/kilsythanderson/>

Church Magazine <https://www.kilsythandersonchurch.org/magazines/>

Church life

<https://www.localprayers.com/GB/Kilsyth/137656083083912/Kilsyth-Anderson-Church>

Local Kirks <https://www.kilsythdistrictchurches.org/>

Local information <https://www.undiscoveredscotland.co.uk/kilsyth/kilsyth/index.html>

Balmalloch Primary School <https://blogs.glowscotland.org.uk/nl/balmalloch/>

Kilsyth Academy <https://www.kilsythacademy.org.uk/>

Banton Primary School <https://blogs.glowscotland.org.uk/nl/banton/about-us/>

Applications

Please apply, enclosing a CV, to the Clerk to the Nominating Committee

Name : Miss Olivia Brittian

Address : 10 Strone Gardens, Kilsyth, G65 9LR

Telephone : 01236 824820

E-mail : obrittian@aol.com

Informal enquiries may be made to the Interim Moderator, Rev John MacGregor

Email JMacGregor@churchofscotland.org.uk

Telephone : 0141 576 7127

Closing date : Thursday 30th September 2021.